

VIBRATION ISOLATOR
RESTRAINED
Model : PTM-D & PTM-DS
INSTALLATION
OPERATION
AND
MAINTENANCE MANUAL

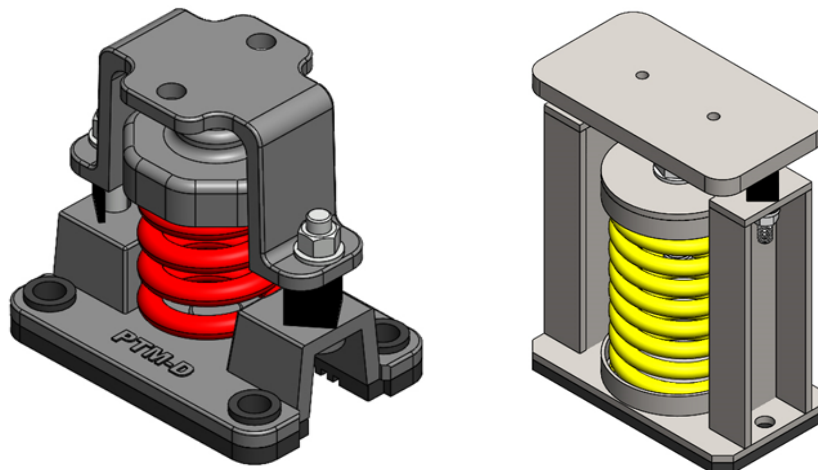

Model: PTM-D

● **Component**

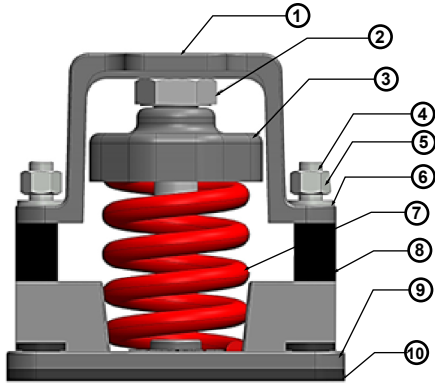

Model : PTM-D

No.	Part
1	Upper Plate
2	Leveling Bolt
3	Upper Mounting Cup
4	Restraining Bolt
5	Restraining Nut
6	Restraining Washer
7	Spring Element
8	Spacer
9	Lower Plate
10	Rubber Pad

● **Installation**

1. Check and adjust Leveling Bolt to attach with Upper Plate

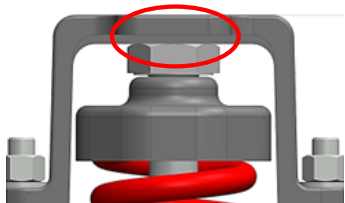

2. Install vibration Isolator and equipment at the specified position. Fill water in the system (Vibration Isolator should be on operating level before adjustment)

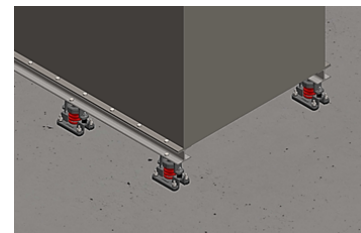

3. Arrange the position and adjust height of Vibration Isolator as Operating Height (H). (H is according to Tozen Catalogue).

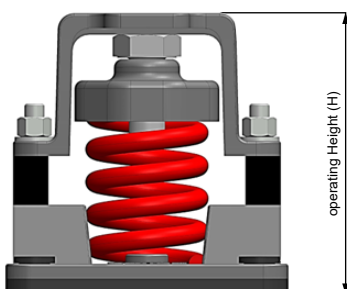

4. Loose all Restraining Nut for gap around 2-3mm. Between Restraining Nut and Restraining Washer.

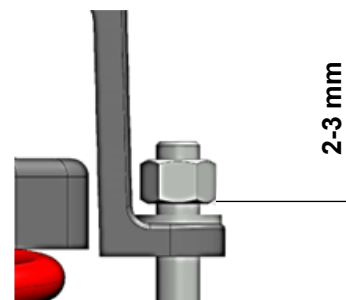

5. Transfer loads of equipment to spring by screwing Leveling Bolt in clockwise for 2 rounds.

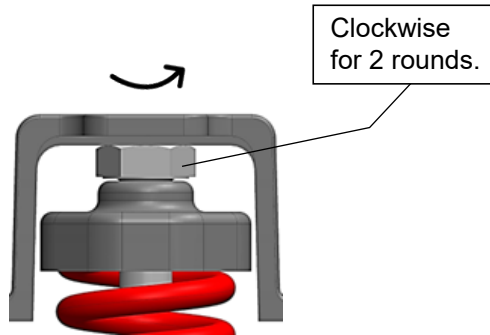

6. Repeat step 5 with Vibration Isolator for every each until spring compressed and spacer loosen enough to take off.

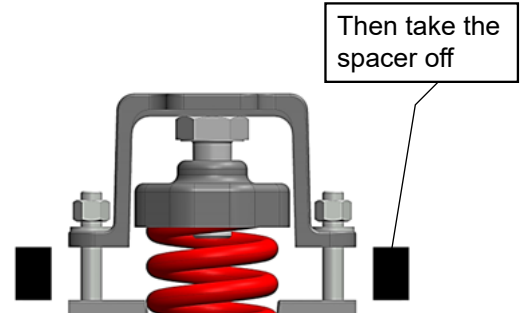

7. Check level of equipment and adjust Vibration Isolator by screwing Leveling Bolt. Counterclockwise for lifting and Clockwise for laying down.

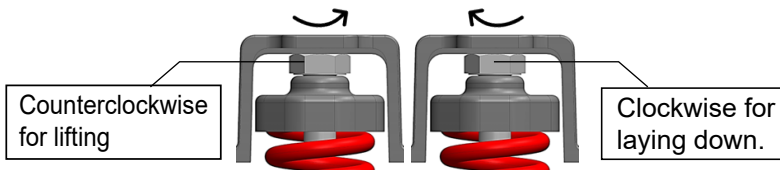

8. After finished adjustment then adjust Restraining Nut for gap 2-3mm.

9. Tight every bolts to fix Vibration Isolator

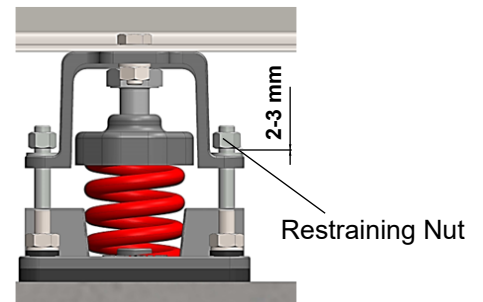

Model: PTM-DS

• **Component**

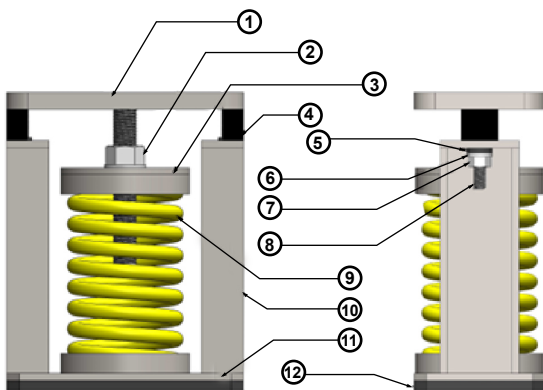

Model : PTM-DS

No.	Part
1	Upper Plate
2	Leveling Bolt
3	Upper Mounting Cup
4	Spacer
5	Rubber Bush
6	Res training Washer
7	Res training Nut
8	Res training Bolt
9	Spring Element
10	C-Channel
11	Lower Plate
12	Rubber Pad

● **Installation**

1. Check and adjust Leveling Bolt to attach with Upper Plate

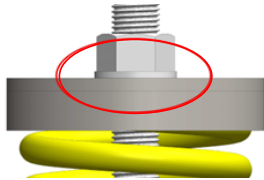

2. Arrange the position and adjust height of Vibration Isolator as Operating Height (H). (H is according to Tozen Catalogue).

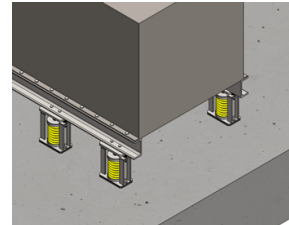

3. Install vibration Isolator and equipment at the specified position. Fill water in the system (Vibration Isolator should be on operating level before adjustment)

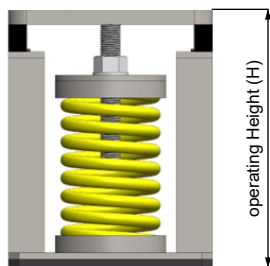

4. Loose all Restraining Nut for gap around 2-3mm. Between Restraining Nut and Rubber Bush.

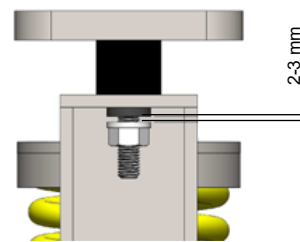

5. Transfer loads of equipment to spring by screwing Leveling Bolt in clockwise for 2 rounds.

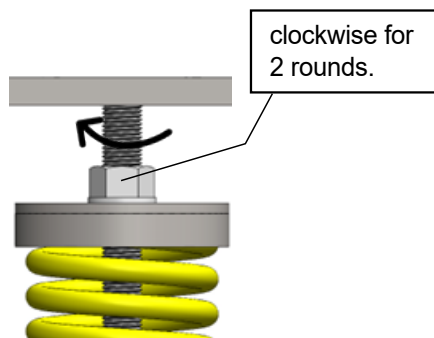

6. Repeat step 5 with Vibration Isolator for every each until spring compressed and spacer loosen enough to take off.

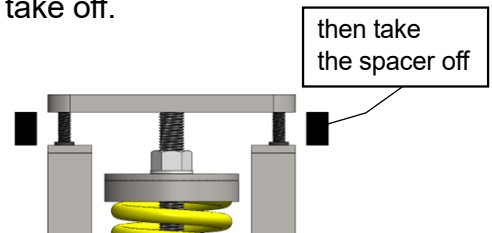

7. Check level of equipment and adjust Vibration Isolator by screwing Leveling Bolt. Counterclockwise for laying down and Clockwise for lifting.

8. After finished adjustment then adjust Restraining Nut for gap 2-3mm.

9. Tight every bolts to fix Vibration Isolator

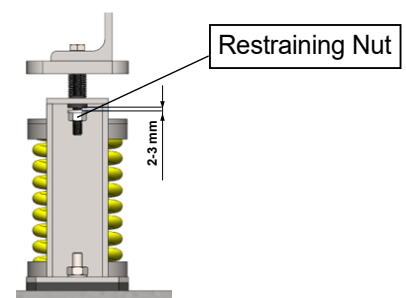



TOZEN INDUSTRIAL CO., LTD.

3388/62 18TH FLOOR, SIRINRAT BLDG.,
RAMA IV RD., BANGKOK 10110 THAILAND
TEL : (66) 0-2029-0100
FAX : (66) 0-2029-0111
URL : www.tozen.co.th

TOZEN CORPORATION

8-4, ASAHI YOSHIKAWA
SAITAMA 342-008 JAPAN
TEL : 048-993-1030
FAX : 048-993-1038